

## WATER YOU CAN TRUST

The Pentair Everpure EF-Series introduces great-tasting, crisp, clean filtered water at every regular tap in your home. The highly engineered submicron design rids water of unwanted lead and chemical impurities while maintaining a high capacity, full flow for your home.

Substance Reduction	EF-1500	EF-3000	EF-6000
Chlorine Taste & Odor	•	•	•
Damaging Limescale*	•	•	•
Dirt & Cloudiness*	•	•	•
Cysts**	•	•	•
Lead	•	•	•
Reduces particles as small as 0.5 micron in size by mechanical means	•	•	•
Molds & Algae*	•	•	•
Off Tastes & Odors*	•	•	•
Oxidized Iron, Oxidized Manganese & Sulfides*	•	•	•
Bacteriostatic Control			•
Capacity (gallons)	1500	3000	6000

\*As tested by Everpure, LLC.

\*\*NSF/ANSI Standard 53 certified to reduce cysts such as Cryptosporidium and Giardia by mechanical means

\*\*\*Treated to inhibit biofilm and microbial build-up in the filter that can decrease product life.

EPA EST. NO. 002623-IL-002



800-942-7873

info@filterpure.com

Contact Filter Pure to learn more about the new EF-Series.

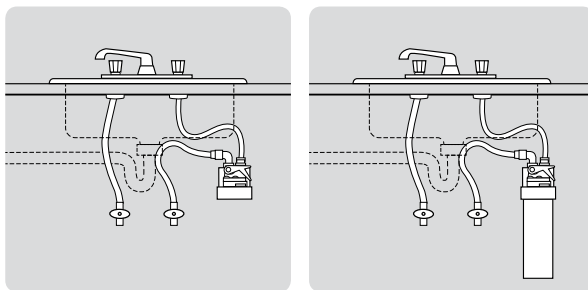

System Tested and Certified by NSF International against NSF/ANSI Standard 42 and 53 for the reduction of the claims specified on the Performance Data Sheet



### WATER QUALITY SYSTEMS

5730 NORTH GLEN PARK ROAD, MILWAUKEE, WI 53209

P: 262.238.4400 | F: 262.238.4404

RESIDENTIAL.EVERPURE.COM

CUSTOMER CARE: 800.279.9404 | tech-support@pentair.com

© 2015 Pentair Residential Filtration, LLC. All rights reserved.

\*For a detailed list of where Pentair trademarks are registered, please visit [waterpurification.pentair.com](http://waterpurification.pentair.com). Pentair trademarks and logos are owned by Pentair, Inc. or its affiliates. Third party registered and unregistered trademarks and logos are the property of their respective owners.

4003263 REV B JA16



## EF-SERIES

### FULL FLOW FILTRATION SYSTEMS

Enjoy the great taste of Everpure everywhere in your home.

# EF-SERIES

## EASILY INSTALL ANYWHERE

Pentair Everpure<sup>+</sup> is making it easy to have *Everpure Everywhere*. The new EF-Series fits virtually anywhere in the household: bathroom, kitchen, pot-filler, wet bar, outdoor kitchen, coffee & espresso machine, ice maker— you name it! Everpure commercial-grade water filtration is now available wherever you are using and consuming water.

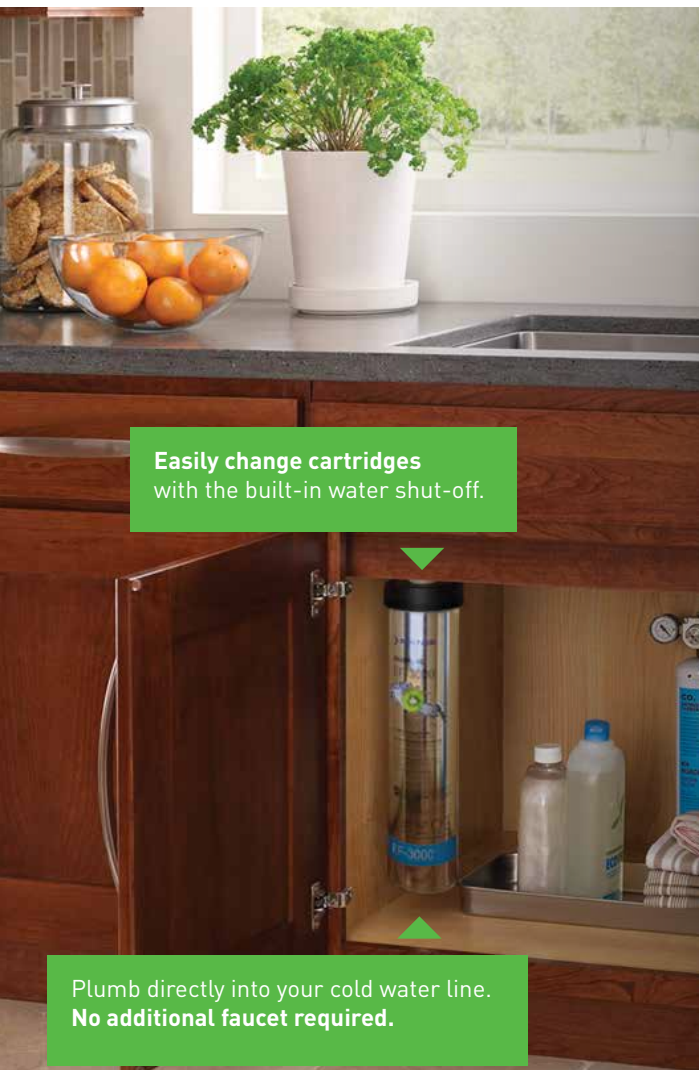

Easily change cartridges  
with the built-in water shut-off.

Plumb directly into your cold water line.  
No additional faucet required.

## EF-1500

EV985800

The smaller canister size is ideal for use in the bathroom or **wherever space is limited.**



1500  
gallons

CAPACITY  
5,600 Litres



15"

## EF-3000

EV985700

The EF-3000 drinking water system works well throughout your entire home.

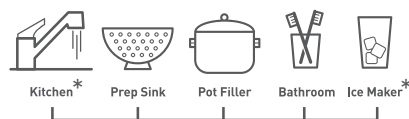

3000  
gallons

CAPACITY  
11,356 Litres



20"

## EF-6000

EV985500

The high capacity of the EF-6000 is perfect for the family kitchen or **any high capacity area.**



6000  
gallons

CAPACITY  
22,712 Litres



22"

## COMMERCIAL-GRADE FILTRATION, WHEREVER YOU NEED IT.

The same commercial quality that makes Pentair Everpure the overwhelming choice for water filtration in restaurants is also available anywhere in your home—**now without the need for extra faucets.** The new EF-Series of full flow drinking water systems brings commercial-grade filtration anywhere in your home using our proprietary Fibredyne technology.

## FIBREDYNE FILTRATION TECHNOLOGY

- Features wet molded fiber structure
- Reduces particles as small as 0.5 micron in size by mechanical means
- Holds more dirt than a standard carbon block
- Includes powdered carbon mix



Contact your local  
distributor to learn more  
about the new EF-Series.

800-942-7873  
info@filterpure.com

\*Kitchen faucet and ice maker can be "Tee'd" together"

WWW.RESIDENTIAL.EVERPURE.COM