

INDUSTRIAL OEM M88 100 PSI BAG HOUSINGS



OEM M88 100 PSI Liquid Bag Housings are superb quality vessels for lower pressure applications. They effectively remove dirt, pipe scale, and other substances from process liquids. Quality construction and design assure clean effluent and protection for all downstream equipment.

Unfiltered liquid enters the housing above the filter bag or strainer basket; fills the interior of the housing; and continues through the bag or strainer basket. Solids are trapped inside the filter bag or strainer and easily removed when the housing is serviced.

FEATURES/BENEFITS

Flow rates to 220 gpm (832.7 Lpm)
Dome bottom
Carbon Steel or Stainless Steel construction
Each housing is factory hydro-tested
Low pressure drop with #12 size bag
Zinc-plated 3-bolt swing lid with eye nuts
Buna-N seal-lid
Differential, drain, and vent ports
Zinc-plated carbon steel baskets for Carbon Steel housings; 304 stainless steel baskets for 304 Stainless Steel housings

100 PSI (6.9 bar) pressure rating
2" female NPT connections
Side and bottom outlets
Differential, drain and vent ports
Two-part epoxy paint finish on carbon steel housings, inside and outside; satin finish on Stainless Steel housings on inside and outside
Accepts #12-size bag filters — offers 25% more surface area than standard #2-size bag filters
Adjustable support legs

APPLICATIONS

Chemical
General Industrial
Oil and Gas
Water

OPTIONS

Mesh-lined strainer baskets
Alternative O-ring materials

SPECIFICATIONS

Pressure Rating	100 psi @ 300°F (6.9 bar @ 148.9°C)
Connections	2" NPT
Housing Lid	Zinc-plated 3-bolt swing closure with vent port
Lid & Basket Seals	Buna-N
Inlets/Outlets	Side inlet/bottom outlet, Side inlet/side outlet
Pressure Ports	Two differential ports measure pressure across filter bag
Construction/Finish	Carbon steel w/2-part epoxy finish on inside and outside 304 or 316 Stainless steel w/satin finish on outside
Basket Material	304 Stainless Steel with 9/64" perforations, carbon steel baskets are Zinc-plated
Bag Size	#12
Base	Adjustable tripod leg assembly

DIMENSIONS

#12 BAG DATA

LENGTH		DIAMETER		SURFACE AREA	
IN	30.0	IN	8.0	FT. ²	5.5
MM	762	MM	203	M ²	0.51

All dimensions are approximate.

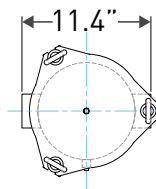

ADJUSTABLE SUPPORT LEGS

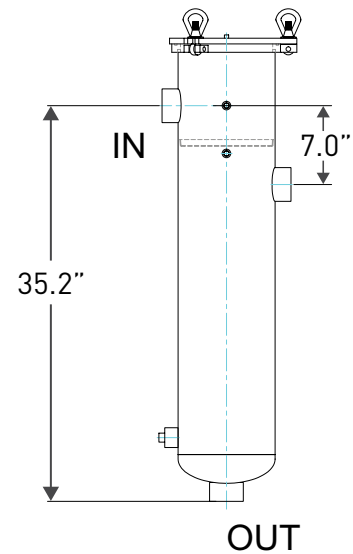
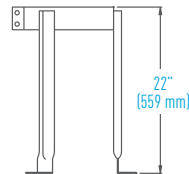
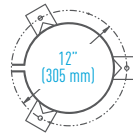

ORDERING INFORMATION

To create your ordering part number, use the part number configurator below.

Custom configurations available. Please contact customer service.

Carbon steel not recommended for water use as the epoxy coating is not designed as a corrosion inhibitor.

HOUSING EXAMPLE: M88302NABC10

M88 Housing (M88), #2 basket (30), 3" (3), Flange connection (F)

Outlet located on bottom and opposite sides (AB), Carbon steel (C), 100 psi (10)

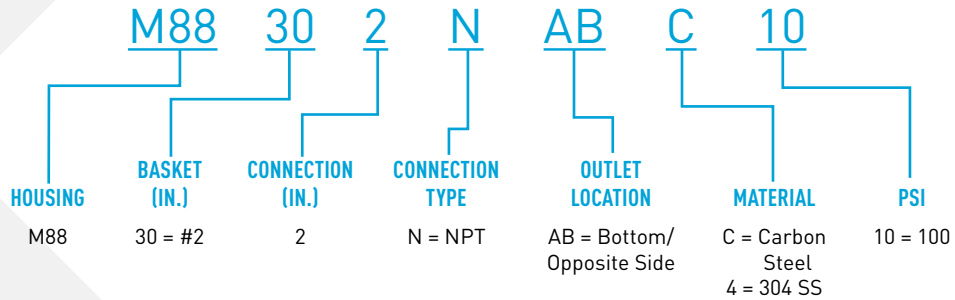



FILTRATION & PROCESS

5730 NORTH GLEN PARK ROAD, MILWAUKEE, WI 53209

P: 262.238.4400 | F: 262.238.4404 | WWW.PENTAIRINDUSTRIAL.COM | CUSTOMER CARE: 800.279.9404

All Pentair trademarks and logos are owned by Pentair, Inc. or its affiliates. All other registered and unregistered trademarks and logos are the property of their respective owners. Because we are continuously improving our products and services, Pentair reserves the right to change specifications without prior notice. Pentair is an equal opportunity employer.

4003038 Rev D DE14 © 2014 Pentair Residential Filtration, LLC. All rights reserved.